

TENANT SPACE

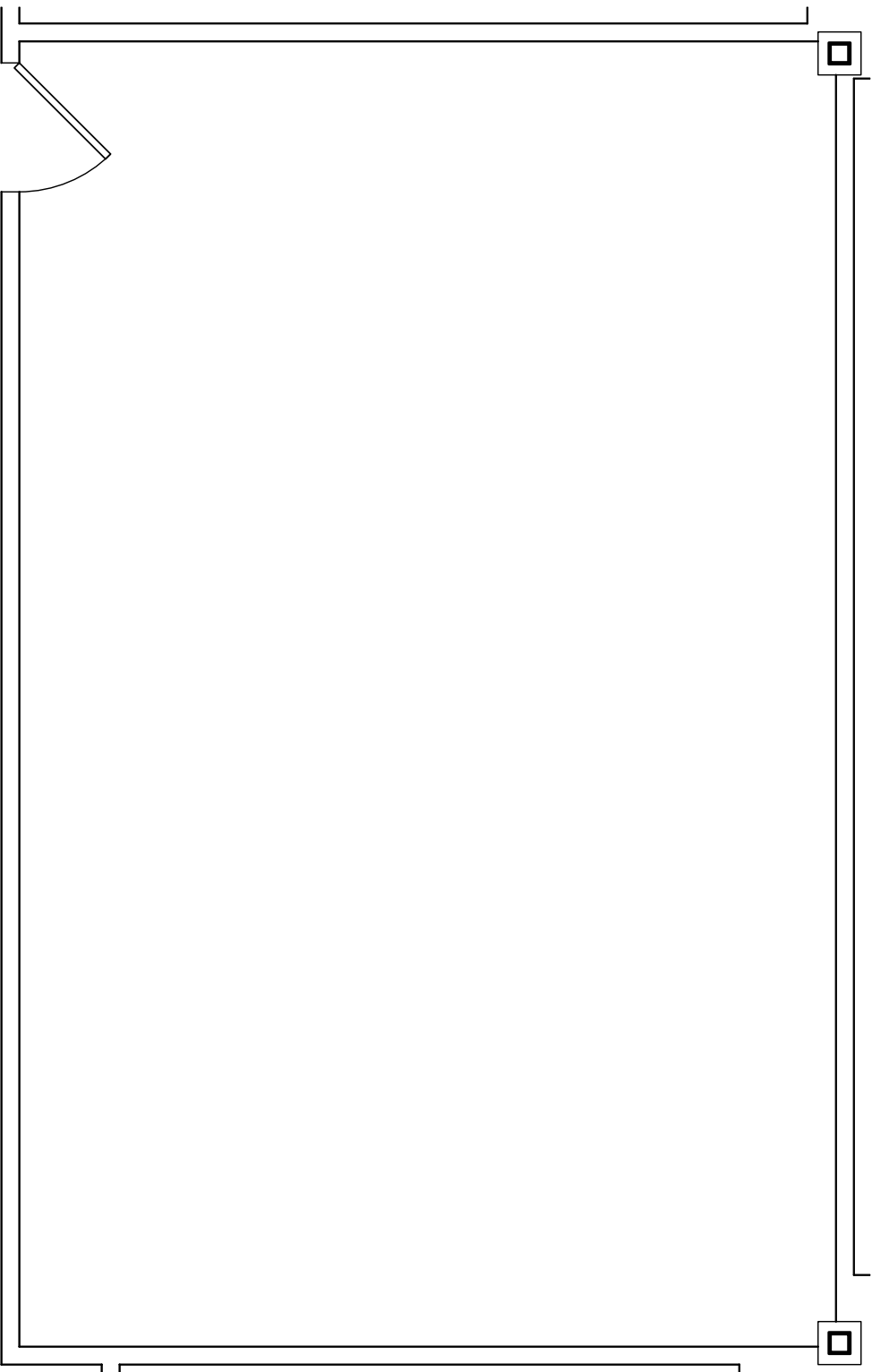

TORRES PARK PLAZA  
8301 WEST JUDGE PEREZ DRIVE  
CHALMETTE, LOUISIANA

SECOND FLOOR  
SUITE 218  
RSF: 705 SQ. FT.

LEASE PACKAGE  
JOB NO.: 06038  
DATE: 07 DECEMBER 2007  
SCALE: 1/4" = 1'-0"

**RWA**  
ROZAS WARD ARCHITECTS  
1010 COMMON ST., SUITE 2750 NO. LA. 70112 504.524.4375